



# SP SERIES

## SINGLE STAGE VACUUM PUMPS

Rugged, Single stage, oil sealed, rotary vane vacuum pumps of Global standard



**SP16**  
**SP40**  
**SP65A**  
**SP100A**  
**SP200**  
**SP300**

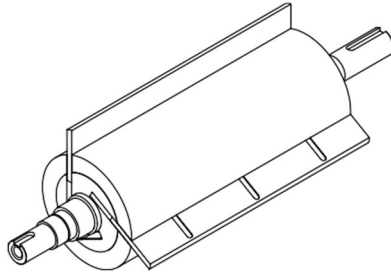

SP series is one of our fastest moving product ranging from 17 to 300m<sup>3</sup>/h pumping speeds. The pumps are suitable for various applications needing vacuum in a spectrum of few hundred mbar to 1mbar.

Variable gas ballast technique ensures lesser oil contamination.

## Features

- Robust and compact
- High pumping speed even at low pressures
- Gas Ballast valve fitted as standard with easy access
- Exhaust mist filter with built-in bypass valve
- Quiet in operation
- Minimal vibration
- Integral anti-suck back valve
- Less oil consumption
- Air-cooled
- Easy to service

## Industry/Markets

- Coating & deposition
- Food processing
- Metallurgy/Furnace
- Power engineering
- Automotive
- Pharmaceutical
- Packaging
- Research & development
- Central vacuum systems
- Laminator

## Typical Applications

- Resin infusion (wind shield)
- Job holding (CNC), pick & place (gantry robot)
- Vacuum material conveying (powder transfer)
- Tray drying, roto-cone evaporator
- Agitated thin film dryer (ATFE)
- Transformer/capacitor vapour phase drying (electrical)
- Vacuum filtration (Chemical)
- Solar lamination
- Resin impregnation
- Capsule filling, blister packing (Pharmaceutical)
- Food packaging

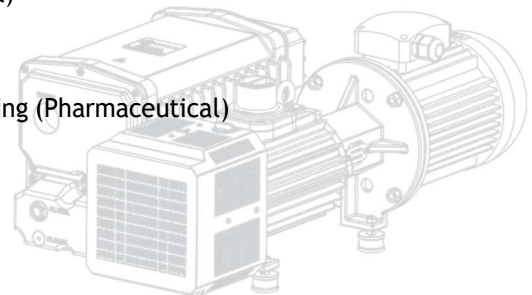

# Performance Curves

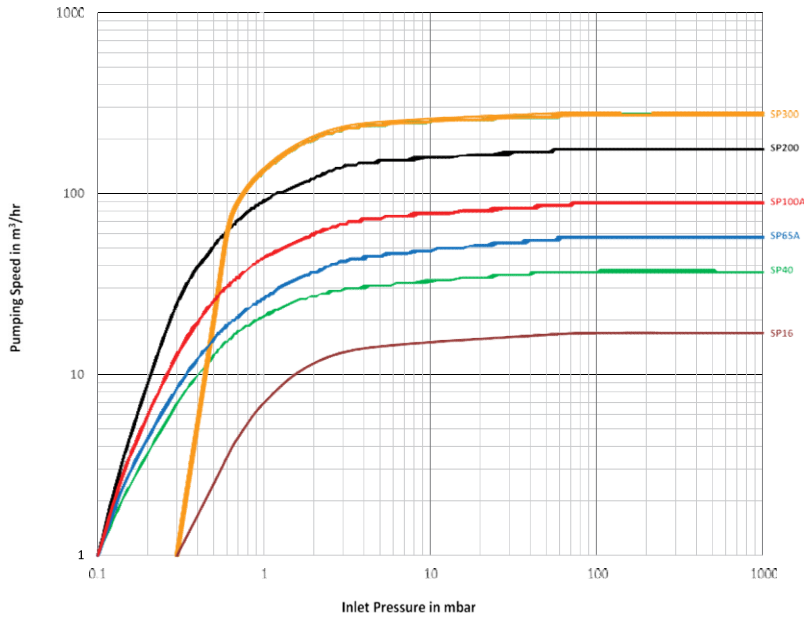

# Specifications

Particulars	Unit	SP16	SP40	SP65A	SP100A	SP200	SP300
Nominal pumping speed @ 50Hz	m <sup>3</sup> /h (L/min)	17 (284)	43 (717)	65 (1083)	102 (1700)	192 (3200)	300 (5001)
Ultimate vacuum (Total pressure)	Gas ballast closed in mbar (Torr)	≤ 0.3 (0.22)	≤ 0.1 (0.07)	≤ 0.1 (0.07)	≤ 0.1 (0.07)	≤ 0.1 (0.07)	≤ 0.3 (0.22)
	Gas ballast open in mbar (Torr)	≤ 1.5 (1.125)	≤ 1.5 (1.125)	≤ 1.5 (1.125)	≤ 1.5 (1.125)	-	-
	Small gas ballast in mbar (Torr)	-	-	-	-	≤ 0.8 (0.6)	≤ 0.8 (0.6)
	Standard gas ballast in mbar (Torr)	-	-	-	-	≤ 1.5 (1.125)	≤ 1.8 (1.35)
	Big gas ballast in mbar (Torr)	-	-	-	-	≤ 2 (1.5)	≤ 2.5 (1.87)
Water vapour pumping capacity	kg/h	0.3	0.9	1.4	2.2	1.5, 2.5, 4*	2.4, 4.5, 6*
Water vapour tolerance	mbar	40	40	40	40	20, 30, 40*	20, 30, 40*
Nominal power rating at 50Hz	kW (HP)	0.75 (1)	0.75 (1)	1.5 (2)	2.2 (3)	3.7 (5)	5.5 (7.5)**
Motor rotational speed at 50Hz	rpm	1500	1000	1500	1500	1500	1500
Weight	kg (lb)	29	53	59	80	139	193
Inlet connection		G 3/4" F	G 1 1/4" F	G 1 1/4" F	G 1 1/4" F	G 2" F	G 2" F
Outlet connection		G 3/4" F	G 1 1/4" F	G 1 1/4" F	G 1 1/4" F	G 2" F	G 2" F
Oil capacity	Lts	1	1.8	1.8	2	7	9
Recommended oil	Standard	IG68					
Power supply		Three Phase 415V, 50Hz***		Three Phase 415V, 50Hz			

\* Small, Standard and Big Gas ballast

\*\* One step higher size motor available

\*\*\* Optional single phase motor available

# Dimensions

**SP16**

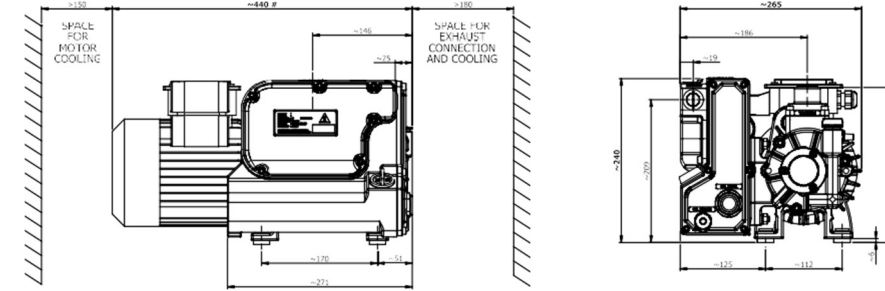

**SP40**

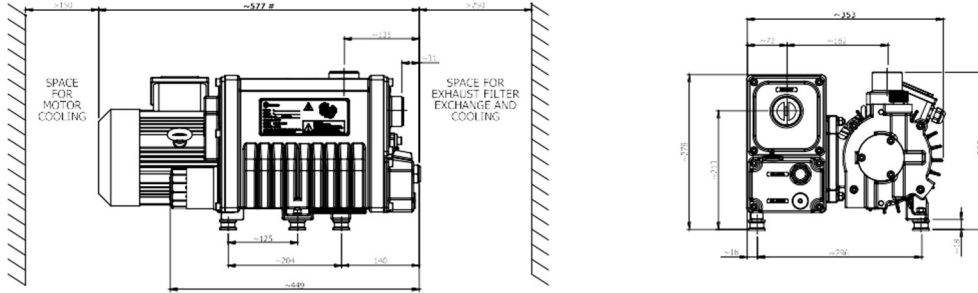

**SP65A**

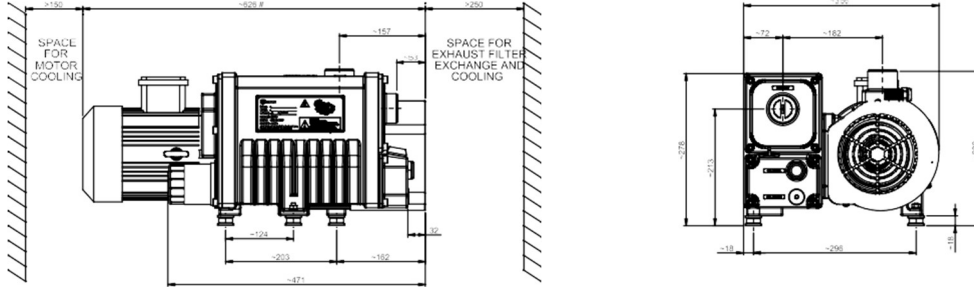

**SP100A**

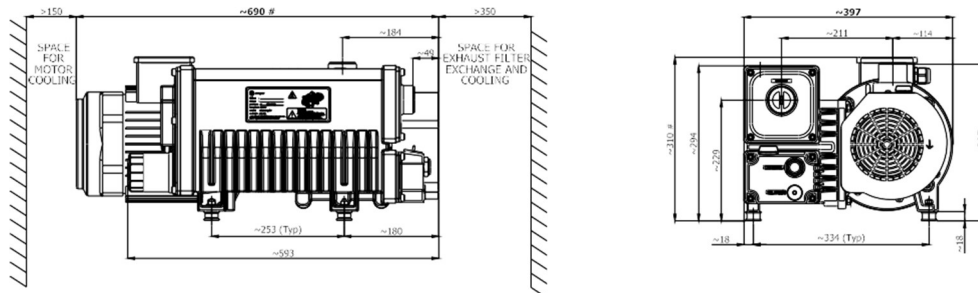

**SP200**

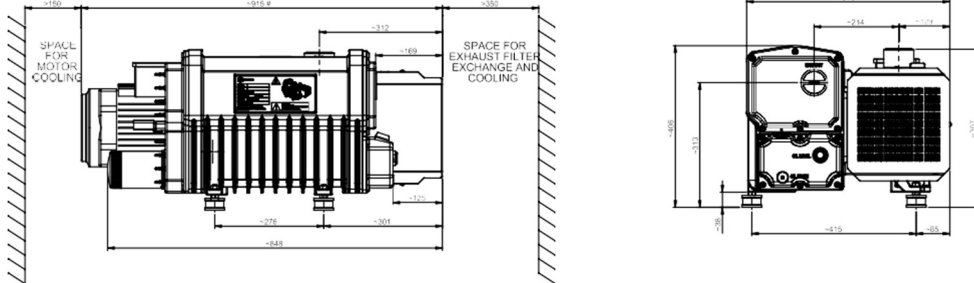

**SP300**

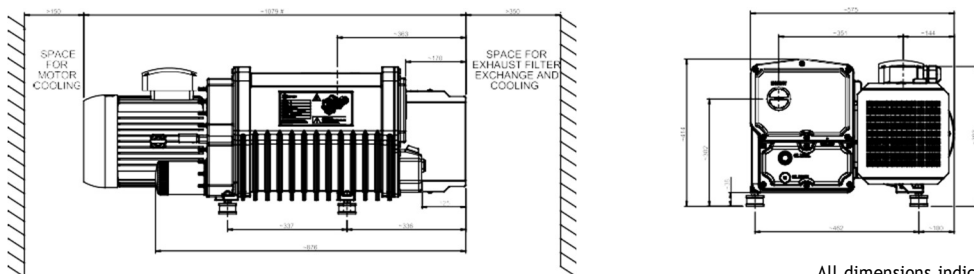

All dimensions indicated above are in



**Authorise Sales & Service Distributor For**



■ Part of Atlas Copco Group